

FAD FOOTING SCHEDULE			
BEIDA	SIZE	THICKNESS	REINFORCEMENT
(A)	2'-0" x 2'-0"	8" CONC	2 #4
(B)	2'-0" x 2'-0"	8" CONC	3 #4
(C)	3'-0" x 3'-0"	8" CONC	3 #4

GILL BOLTING SCHEDULE	
BEIDA	ANCHOR BOLTING
(1)	1/2" A.B. @ 12" O.C.
(2)	1/2" A.B. @ 16" O.C.
(3)	1/2" A.B. @ 24" O.C.
(4)	1/2" A.B. @ 32" O.C.

NOTES

CONCRETE SHALL BE TYPE ALL UNITS
 4000 PSI (40 MPa) WITH 1% MIN. ENHANCEMENT
 OF CONTRACTED PAD

FOOTINGS - 3'-0" x 3'-0" N/A 44 CONT. T&B
 18" N x 24" B N/A 44 CONT. T&B

CHECKS FOUND BY ARCHITECT

CONSTRUCTION PLANS

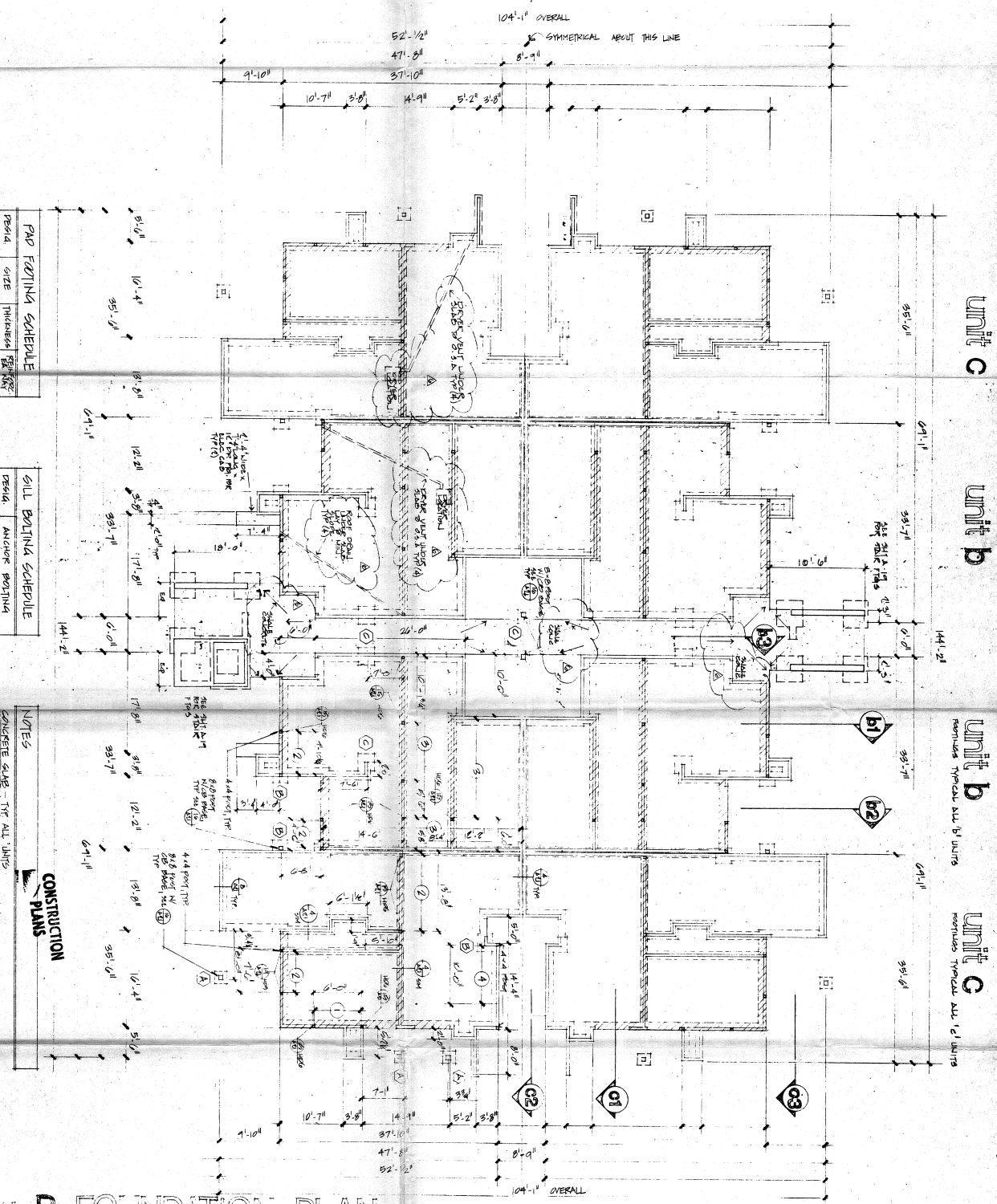

Building B-FOUNDATION PLAN

CRAIG COMBS ASSOCIATES
ARCHITECT
 1535 MONROVIA AVENUE NEWPORT BEACH, CALIF. AREA CODE 714.645.8040

PROJECT
OWNER
DATE
DRAWN
REV
 1
 2
 3
 4
 5
 6
 7
 8
 9
 10
 11
 12
 13
 14
 15
 16
 17
 18
 19
 20
 21
 22
 23
 24
 25
 26
 27
 28
 29
 30
 31
 32
 33
 34
 35
 36
 37
 38
 39
 40
 41
 42
 43
 44
 45
 46
 47
 48
 49
 50
 51
 52
 53
 54
 55
 56
 57
 58
 59
 60
 61
 62
 63
 64
 65
 66
 67
 68
 69
 70
 71
 72
 73
 74
 75
 76
 77
 78
 79
 80
 81
 82
 83
 84
 85
 86
 87
 88
 89
 90
 91
 92
 93
 94
 95
 96
 97
 98
 99
 100